

Thermoelectric cooler TG 3030-12V Recessed



Product Features

Brand Name:	SoliTherm Peltier
Order Number:	3030303
Housing Material:	Stainless steel AISI 304 (V2A)
Ingress protection:	IP 66, Type 4X
Note:	The torque for the mounting nuts should be 4.5 Nm.
Approvals:	CE, cURus, RoHS
Accessories:	 Condensate Kit
Taric Code:	84158300

Technical data TG 3030-12V Recessed

Cooling capacity 95F/95F:	100 BTU
Temperature range:	-4°F - 149°F
Air volume flow (system / unimpeded):	Ambient air circuit: 23 / 44 cfm Cabinet air circuit: 12 / 36 cfm
Mounting:	Recessed
Dimension HxWxD:	4.3 x 6.1 x 5 (2.6) inch
Weight:	4 lbs.
Cut out dimensions:	4.8 x 3.54 inch
Voltage / Frequency:	12 V DC (use NEC Class 2 supply)
Nominal current:	2.8 A
Starting current:	4.3 A
Max. current:	2.9 A
Nominal power:	34 W
Max. power:	35 W
Fuse:	5 A (T)
Connection:	Connection terminal block

Please click on the graphics to download.
 More CAD drawings can be found under [Product Download](#).
 > [Overview product group Thermoelectric coolers](#)

Performance Graph:

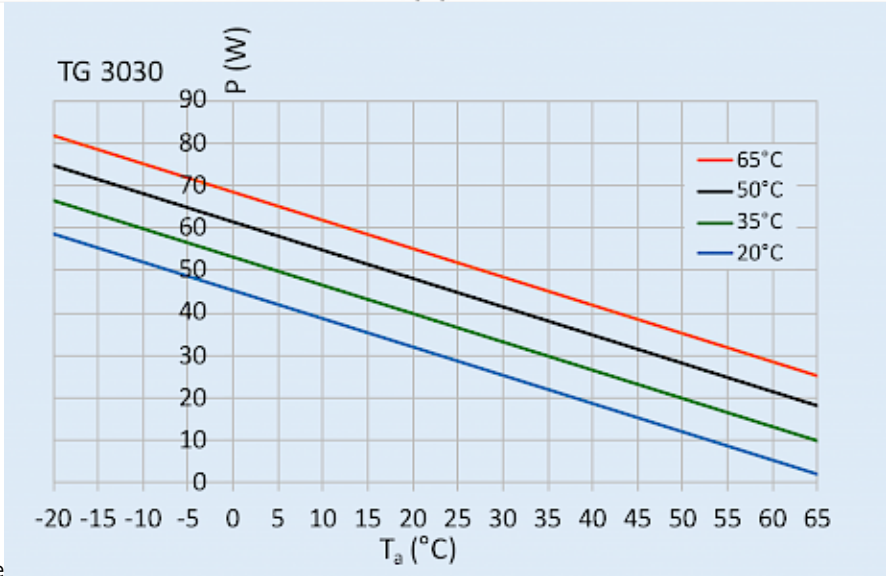
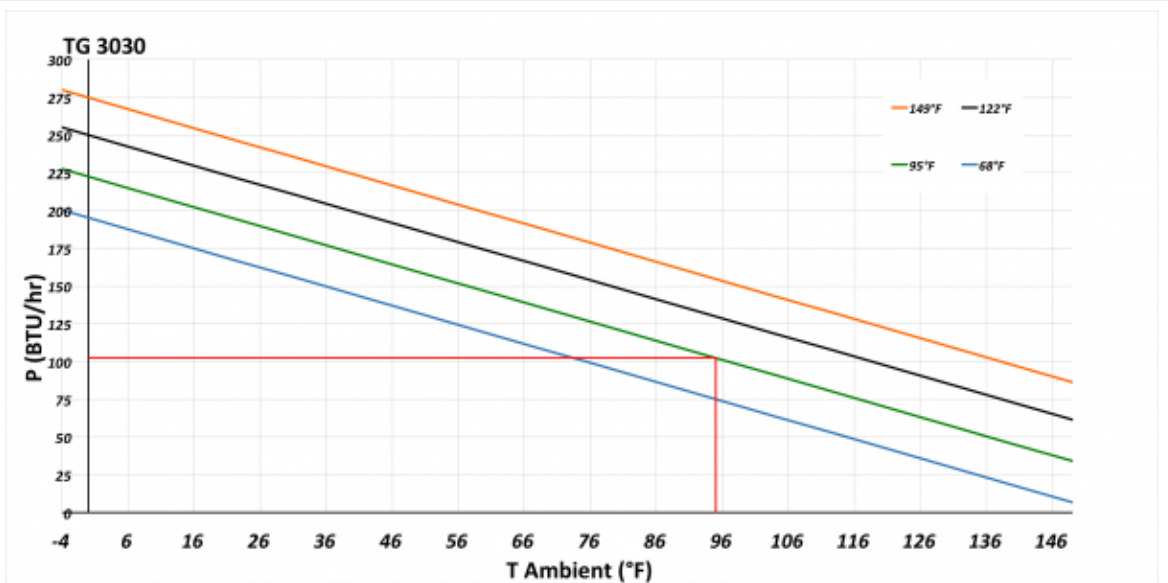

click image to enlarge

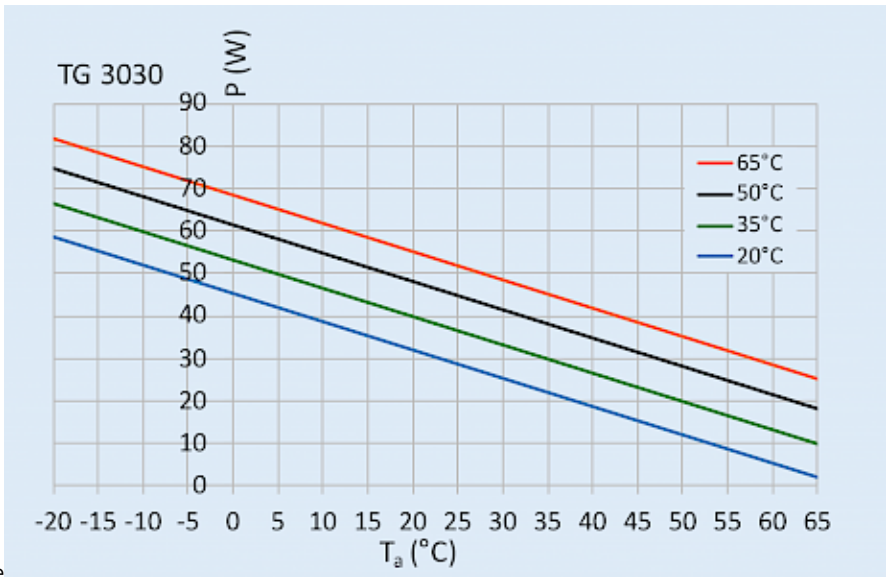

click image to enlarge
click image to enlarge

Air flow:

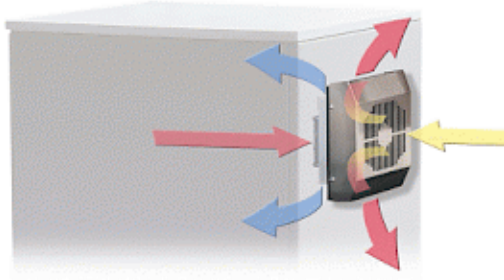

[click image to enlarge](#)

Cut out dimensions:

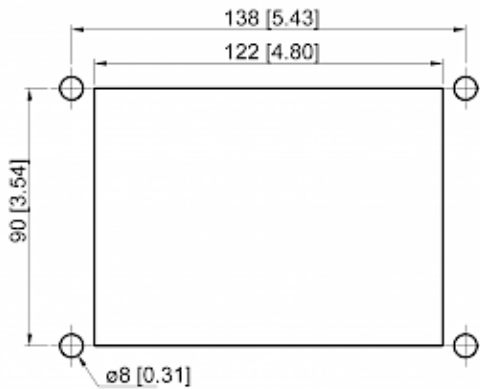

Note:
Primary dimensions in millimeters.
Secondary dimensions in inches.

[click image to enlarge](#)

Product Accessories:



[click image to enlarge](#)